

FINNJET 1977

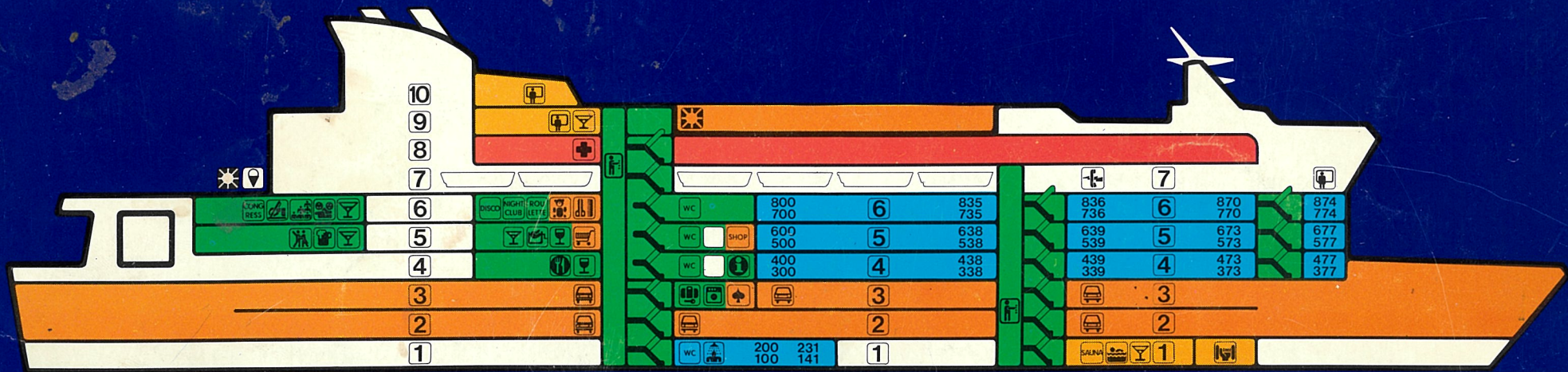

In the forepart of the Finnjet is the hotel section, with "A" and "B" cabins on decks 4, 5 and 6 and "C" cabins on deck 1. The cabin service outlet serves passengers from the centre of the cabin section on deck 6.

"A" CABINS (156)

- 12 sq.m.
- outer cabin with window
- 2 sofa beds + 2 swing-down bunks
- WC and shower
- refrigerator and lockable cupboards
- telephone and radio
- thermostatically-controlled air conditioning adjustable in the cabin
- television connection

Connection doors between 12 pairs of cabins can be opened to form 12 suites.

"B" CABINS (306)

- 8 sq.m.
- 1 sofa bed + upper swing-down bunk
- WC and shower
- telephone and radio
- thermostatically-controlled air conditioning adjustable in the cabin

Forty of the cabins can be combined, thanks to connecting doors.

"C" CABINS (74)

- 4 sq.m.
- 4 fixed beds (2 fixed beds + 2 fixed upper berths)
- radio
- thermostatically-controlled air conditioning adjustable in the cabin.

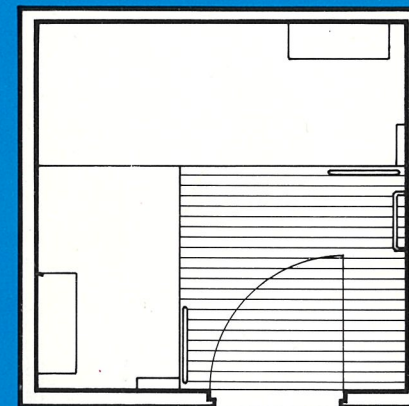
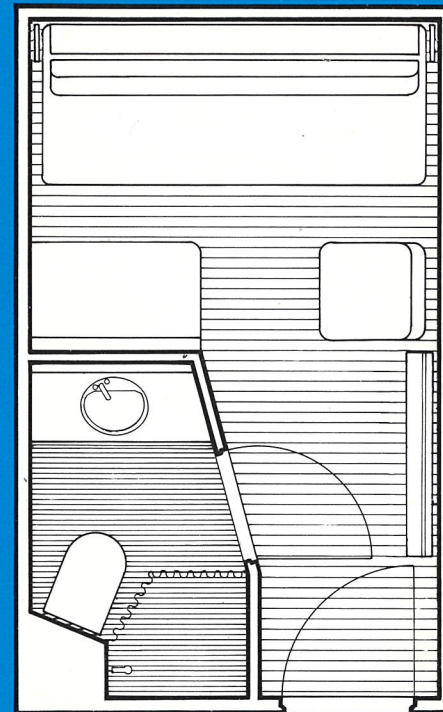
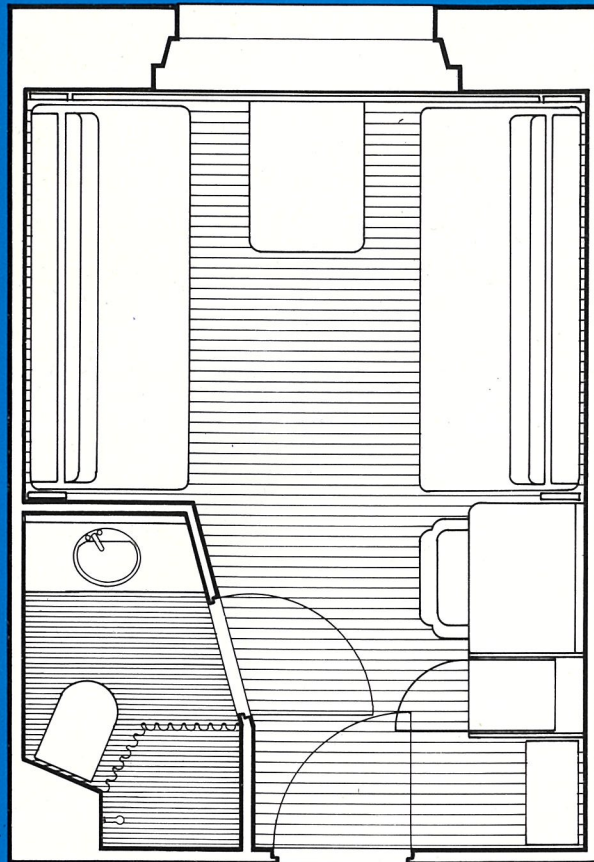



Entrance to an "A" cabin showing the dressing table and cupboards. The "A" cabins are on the outside and each one has a big window affording a good view.

The "B" cabins are inside. Both cabin types have the same WC and shower facilities.

The staircase hall is the centre point of the ship and is approached from two levels. Passengers are guided easily from the hall to the various areas by means of a simple direction system. The lifts and stairs connect every level of the ship, from deck 1 through to deck 9.

The passenger service office is in the hall on deck 4.

Deck 5 has a high class shop.

Deck 6 houses the ship's closed-circuit television and radio studio, which transmits the television programmes receivable in the Baltic area to TV sets in the halls. Various films — even programmes filmed in the lounges — can also be transmitted over the closed-circuit television system.

On the back wall of the hall is an enormous work of art extending through three decks.

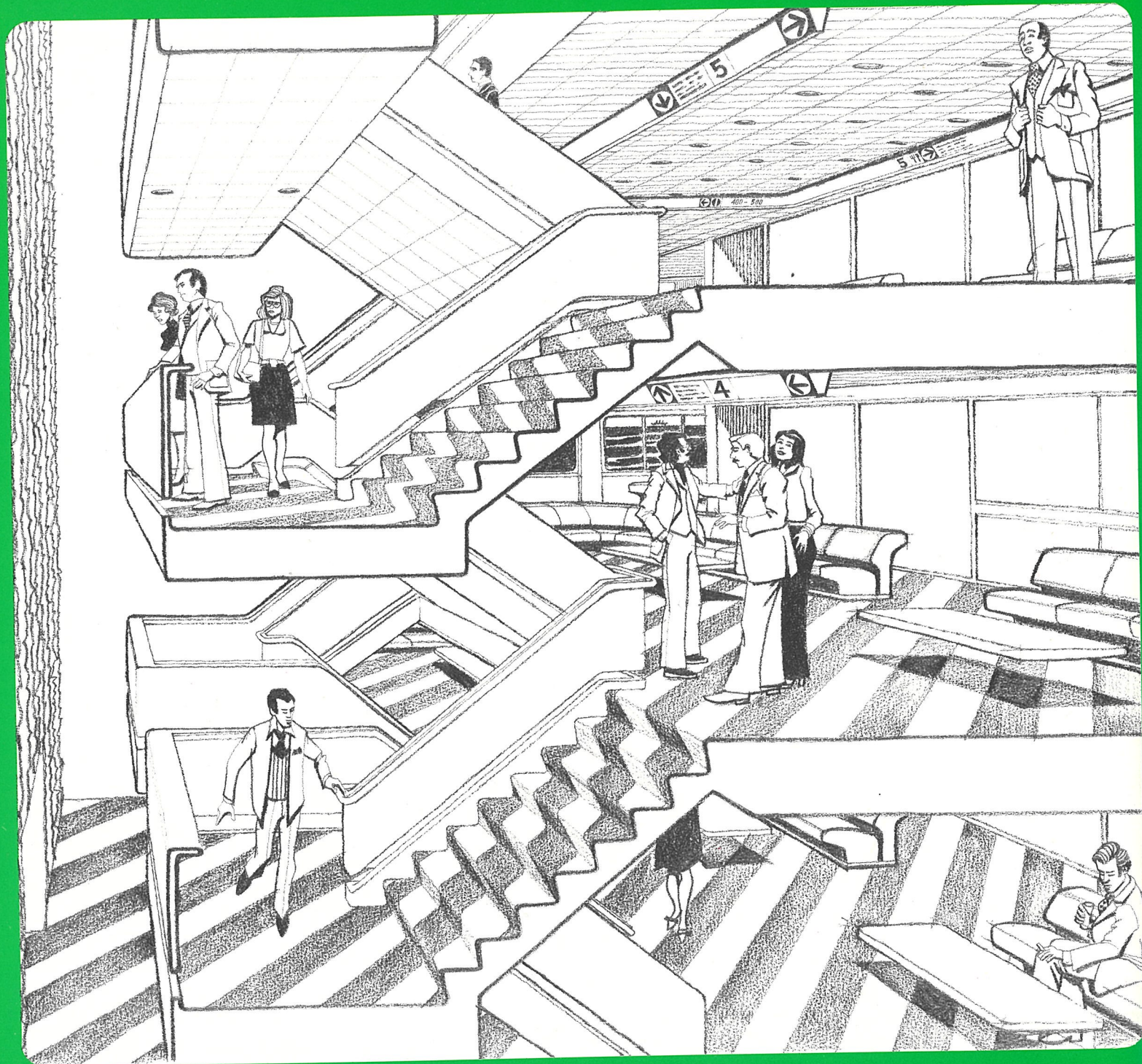

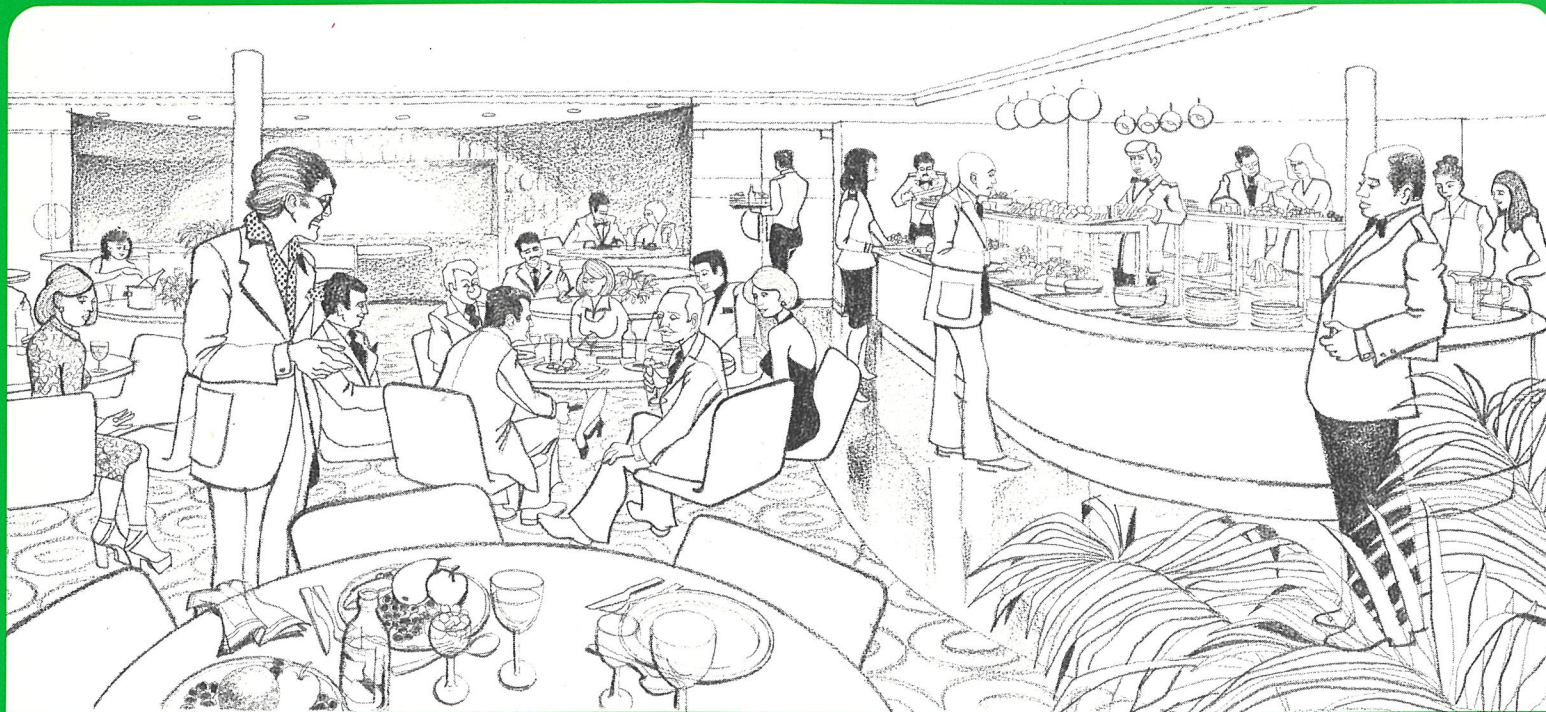

The Finnjet restaurants are in the stern.

The dining room has 312 seats arranged as follows:

- 2 tables for 2
- 10 tables for 4
- 34 tables for 6
- 2 tables for 8
- 4 tables for 12

Additional leaves can extend tables to accommodate groups of up to 30 people. It is also possible to provide seating for an additional 30.

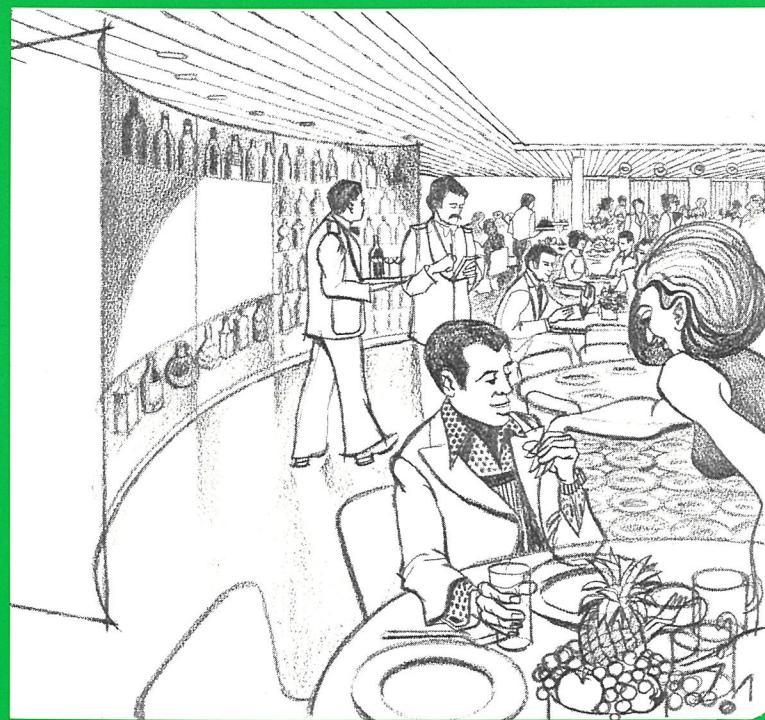

The dining room has 2 large, "U"-shaped buffet tables with a total length of 30 metres, and a big wine cabinet on the back wall.

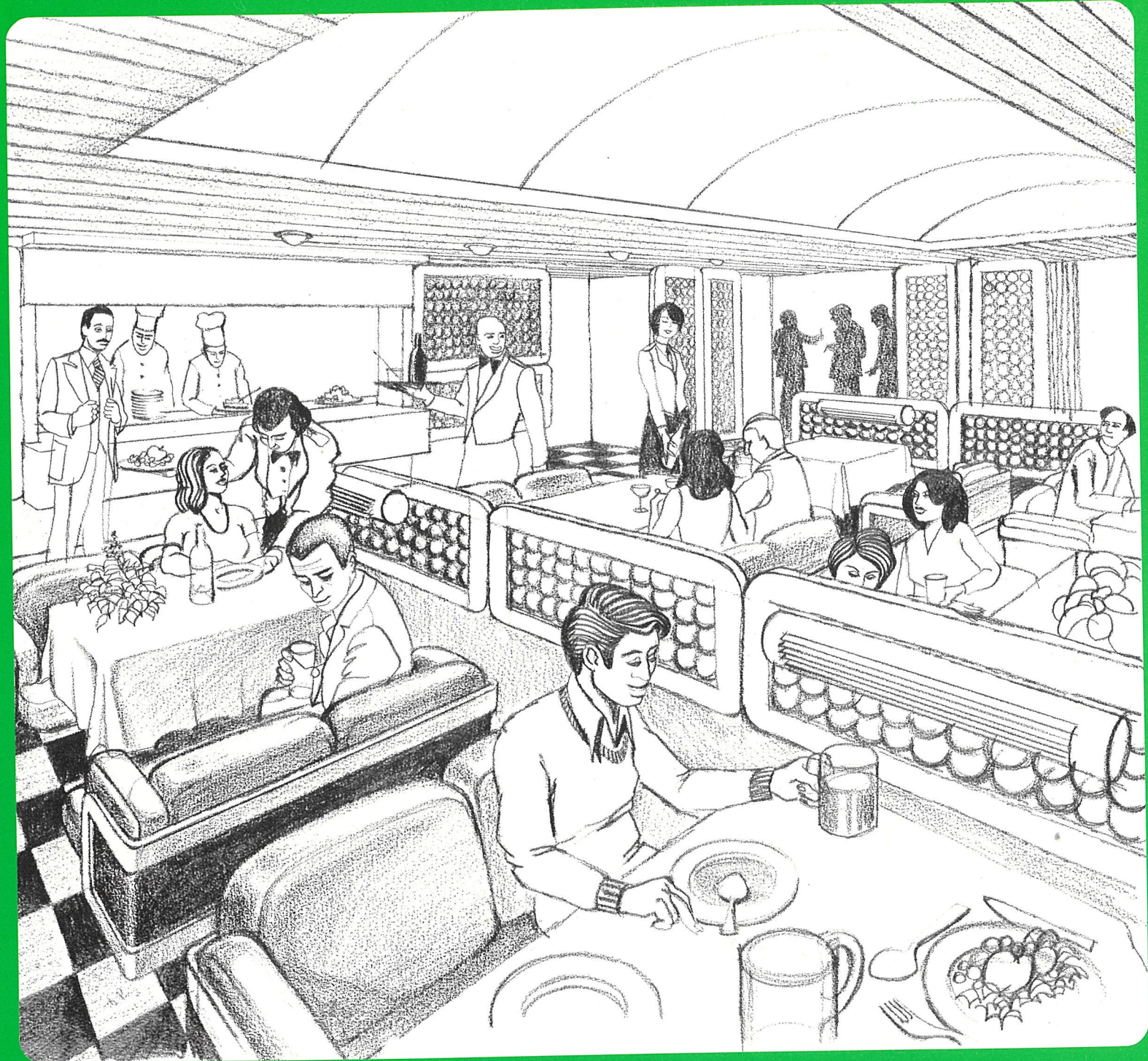

The grill room has 166 sofa seats arranged with
28 tables for 4
9 tables for 6
The restaurant is given special character by the live grill at one end. Outside the grill restaurant is a cocktail bar.

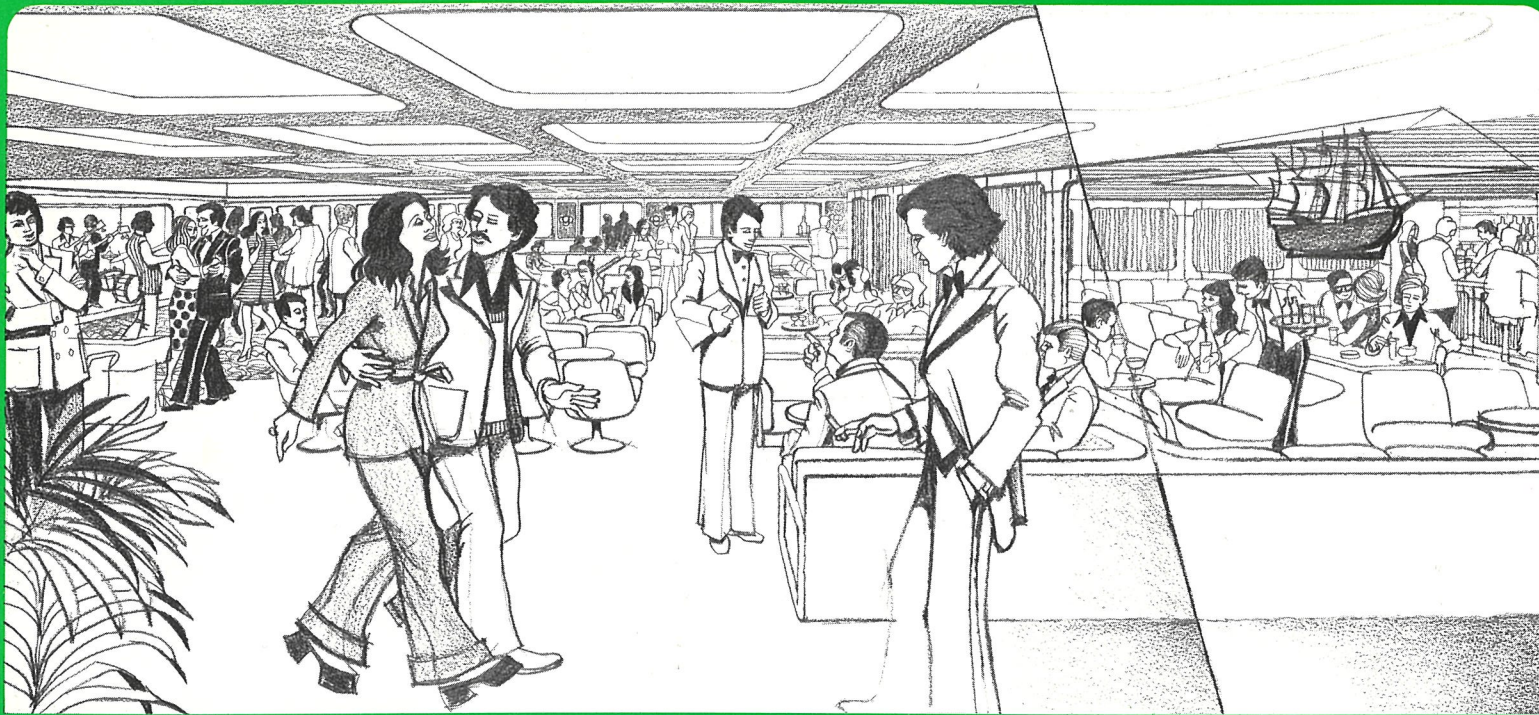

The dancing saloon has seating for 272 and a bar with seating for 46. During the intervals there are "multivision" performances.

The beer saloon is decorated the style of an old ship's saloon, and has seating for 56.

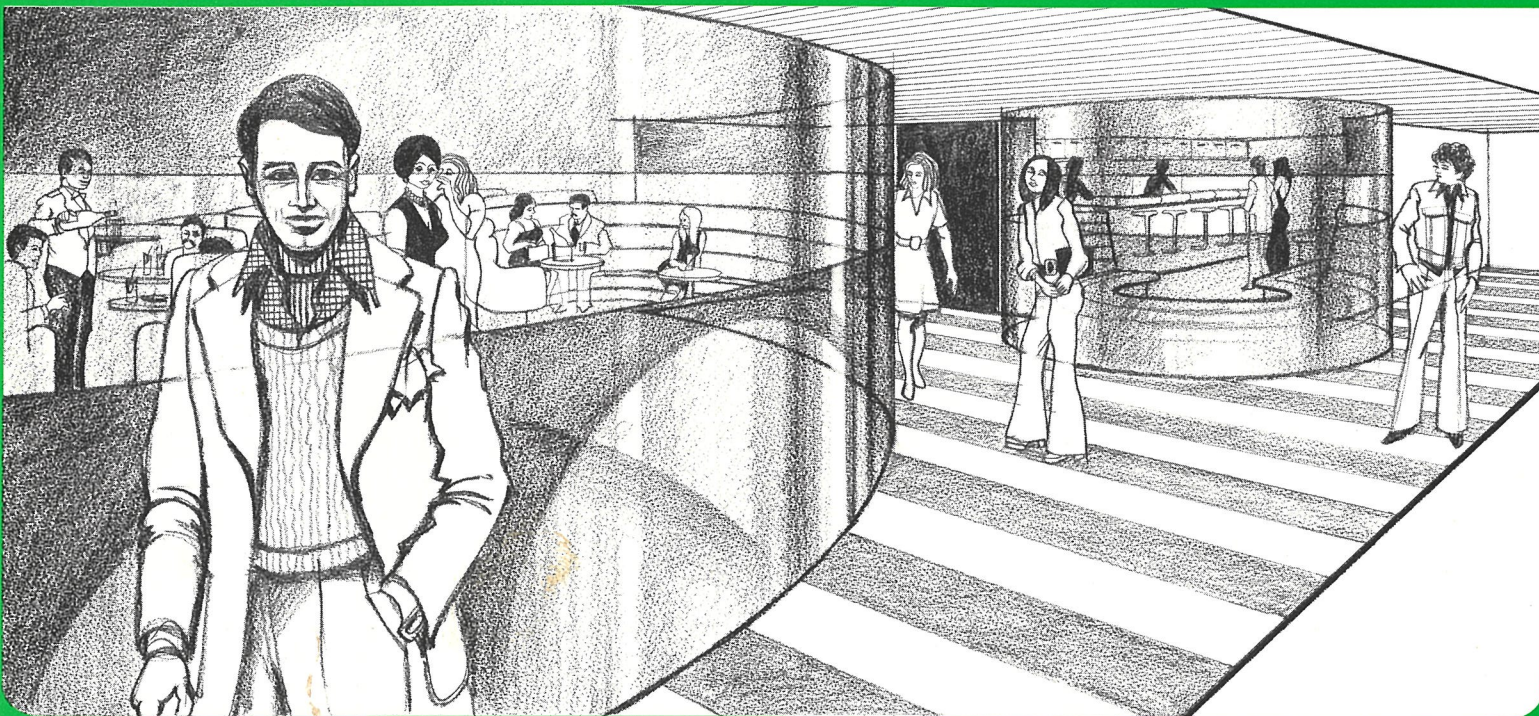

The nightclub seats 160, with 17 at the bar. A coloured light display changes constantly in time to the music. Next to the nightclub is a roulette room.

The 37-seat discotheque has complete disc-jockey equipment and psychedelic lightning.

On the walls of both the nightclub and the discotheque is an illuminated work of art visible from outside as well as inside.

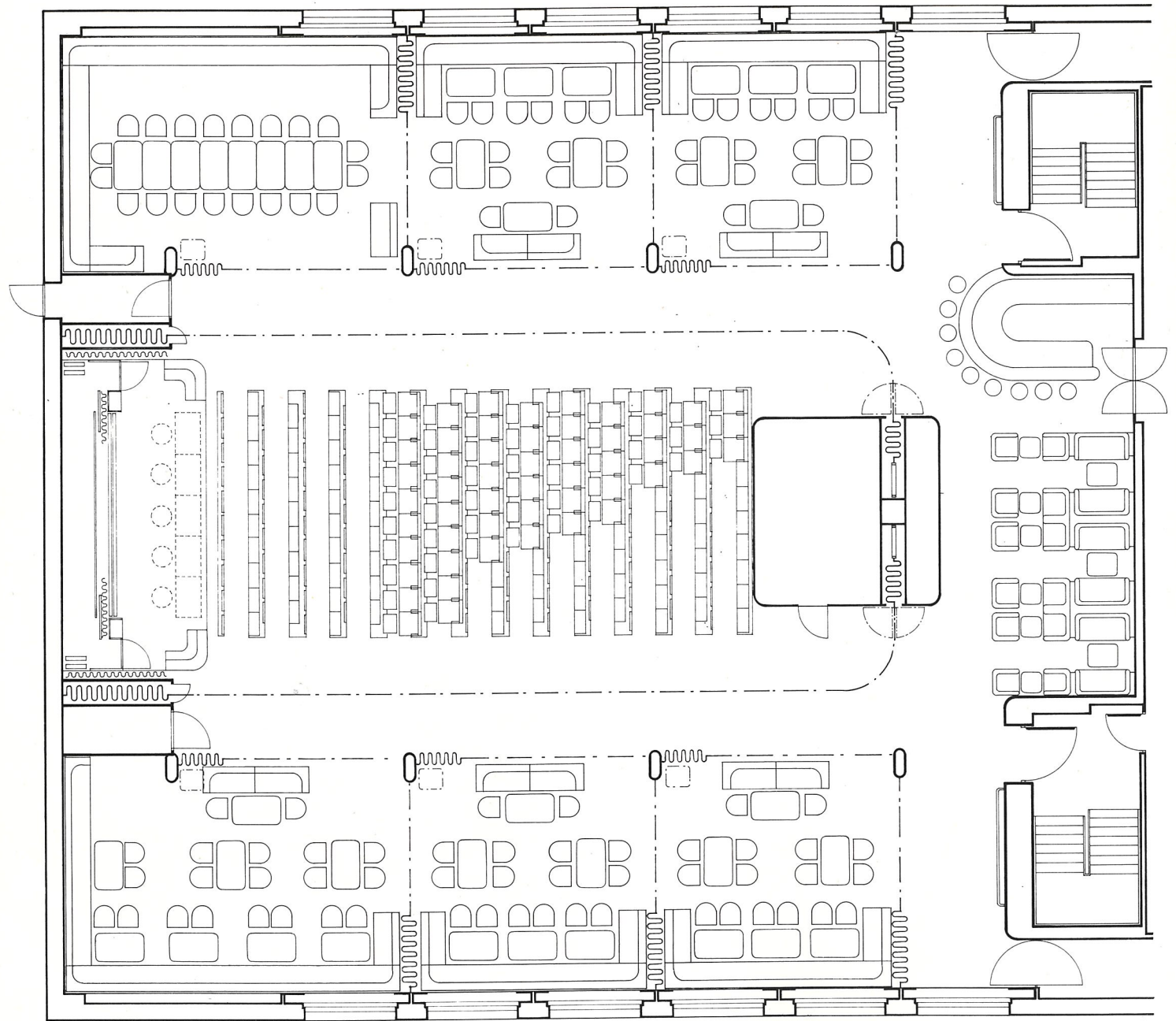

The conference centre.

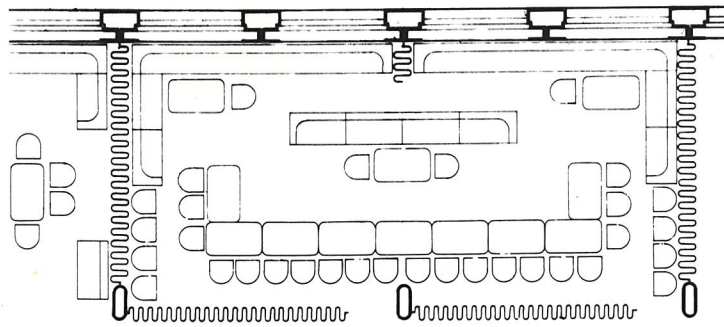
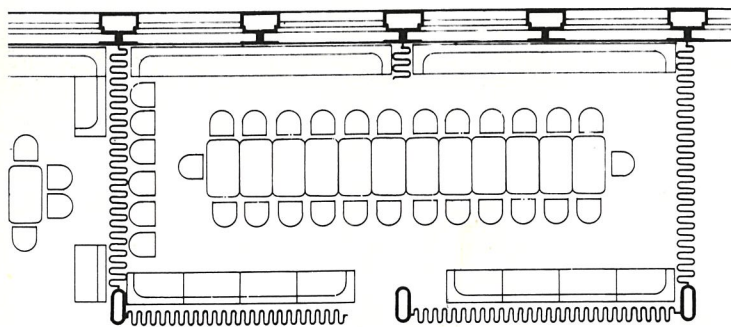
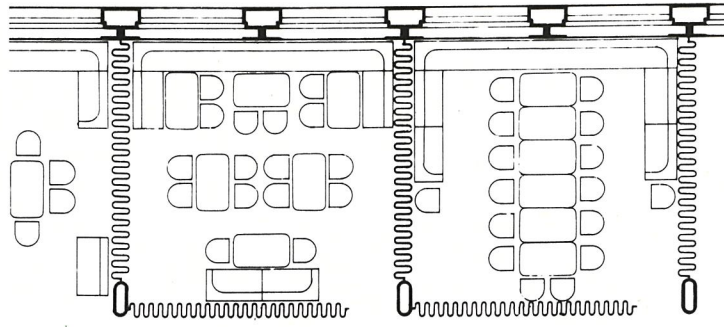
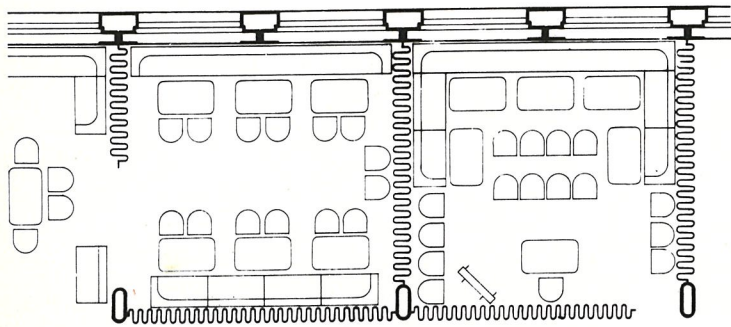

The multi-purpose conference centre seats 377, and can be used either as one big conference hall or as several smaller rooms divided by sound-proof folding partitions. At its hub is the 124-seat main congress room which can also act as a cinema. The areas at the sides can be used for smaller meetings when divided into 2-6 private rooms. There are 110 seats on either side. The smallest private room will accommodate 26 people. When the side areas are not being used for meetings they serve as quiet lounges and reading rooms, and they also have big display cases where permanent exhibits of, for example, design products may be arranged. The entire multi-purpose conference centre is served by a separate 33-seat bar.

Special attention has been paid to the efficiency and comfort of the main congress hall. Each seat has a writing table attached to the seat in front, along with a conference "intercom" device comprising a loudspeaker and a microphone for use in debates. The private rooms at the side also have these intercoms, which may be used either separately or in connection with the equipment in the main congress room. The chairman's dais in the congress room is also suitable for panel discussions.

CONFERENCE EQUIPMENT:

- The meeting rooms and the main congress hall have a videotape recorder, a camera and 7 monitors which can be used to record and play back talks and the like. Speakers can also show their own tapes.
- The film projection room has 16- and 35-mm film projectors and two slide projectors, one with sound control.
- 8- and 16-mm colour films and slides can be transmitted to the television monitors through the studio.
- Normal conference equipment.

The conference area can also be used for shows and demonstrations. There are two 35-mm film projectors (normal and cinemascope lenses) and a 16-mm projector. Sound is reproduced over 4-channel stereo equipment with booster speakers.

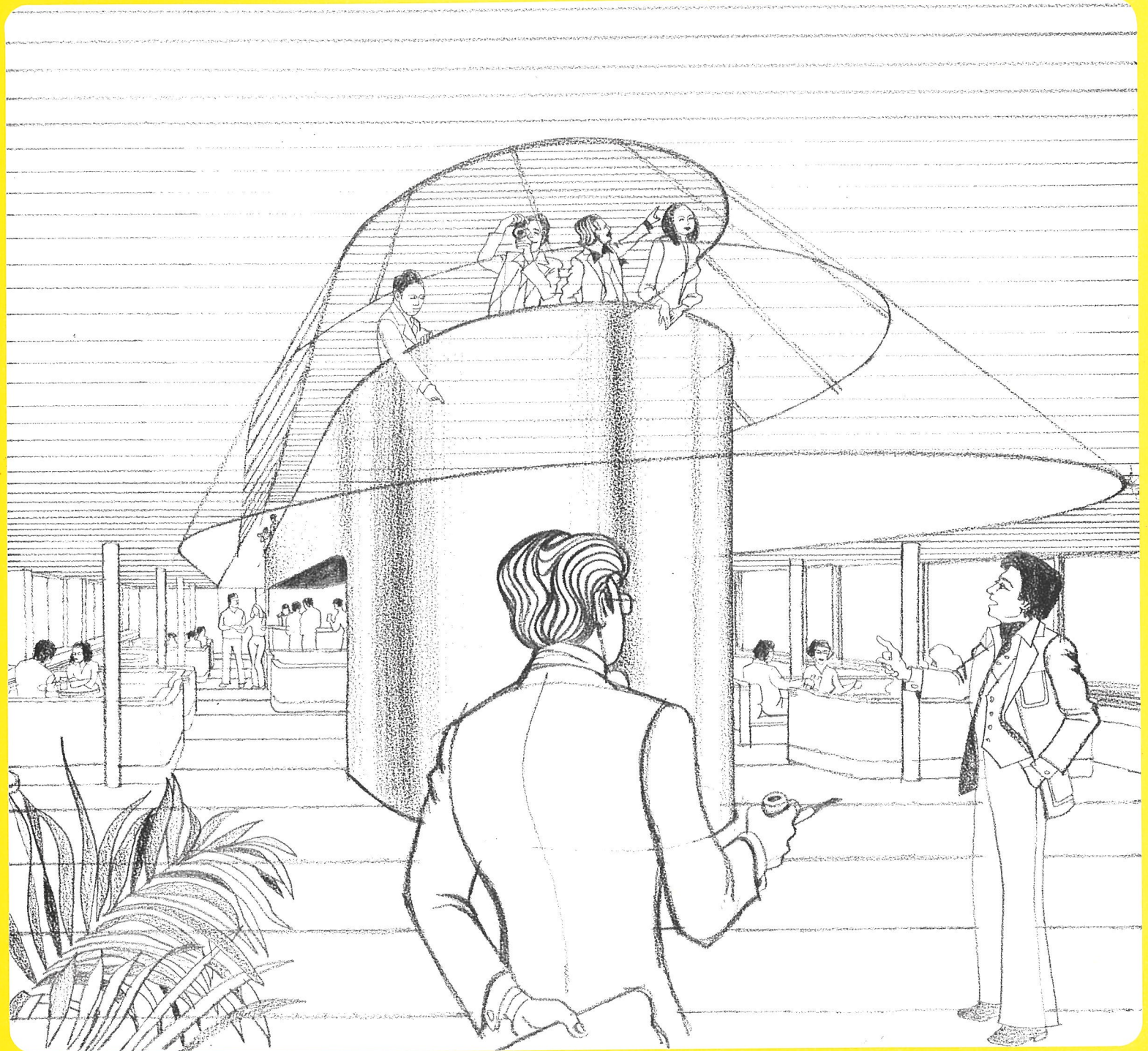

The Panorama Saloon is on deck 9, and has a spiral staircase leading up to the Lighthouse Bar.
— The Panorama Saloon has 117 seats.
— The Lighthouse Bar has 33 seats.
At the front of the Panorama Saloon is a sun deck shielded from the wind.

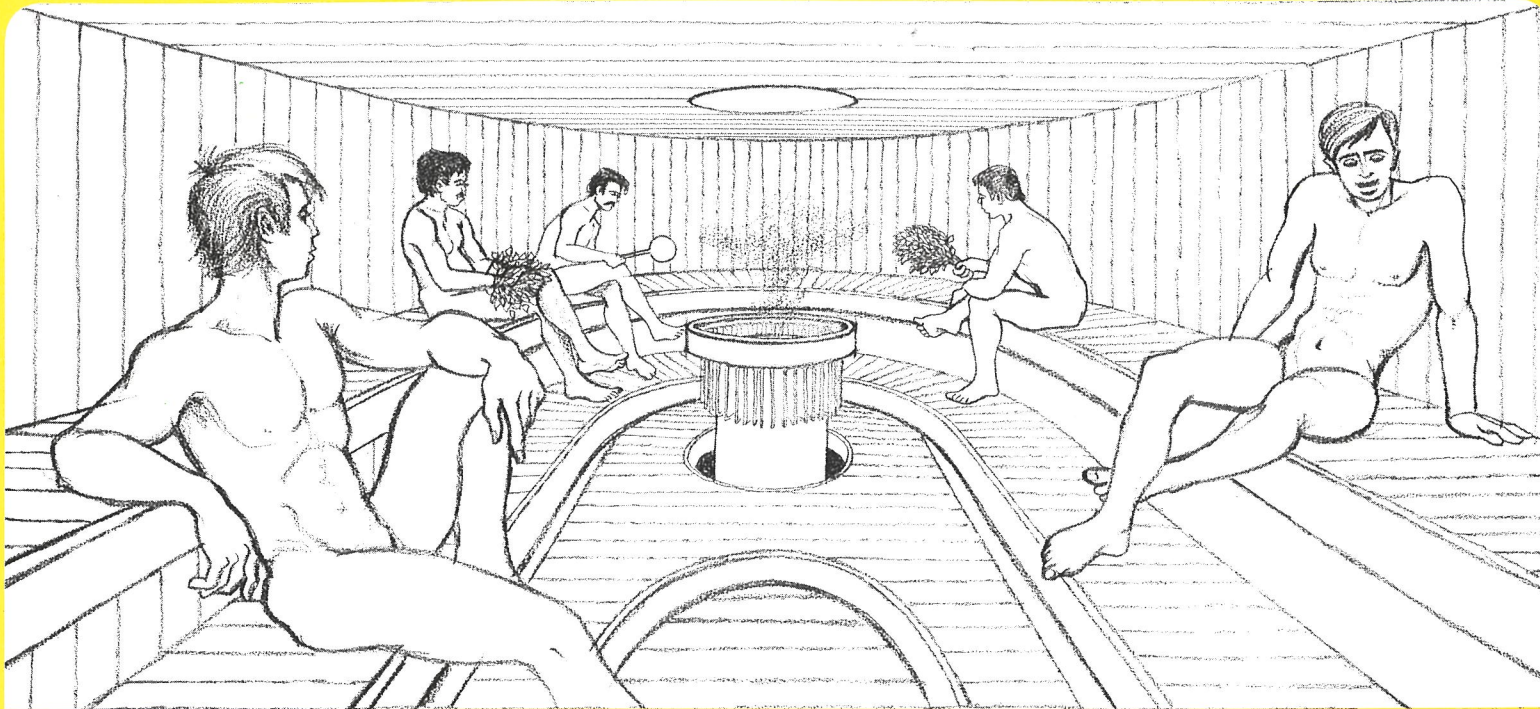

The sauna on deck 1 is reached by lift from the cabin section. Along with three saunas for passengers, there are dressing rooms with big personal lockers and rest areas. Water massage can also be arranged.

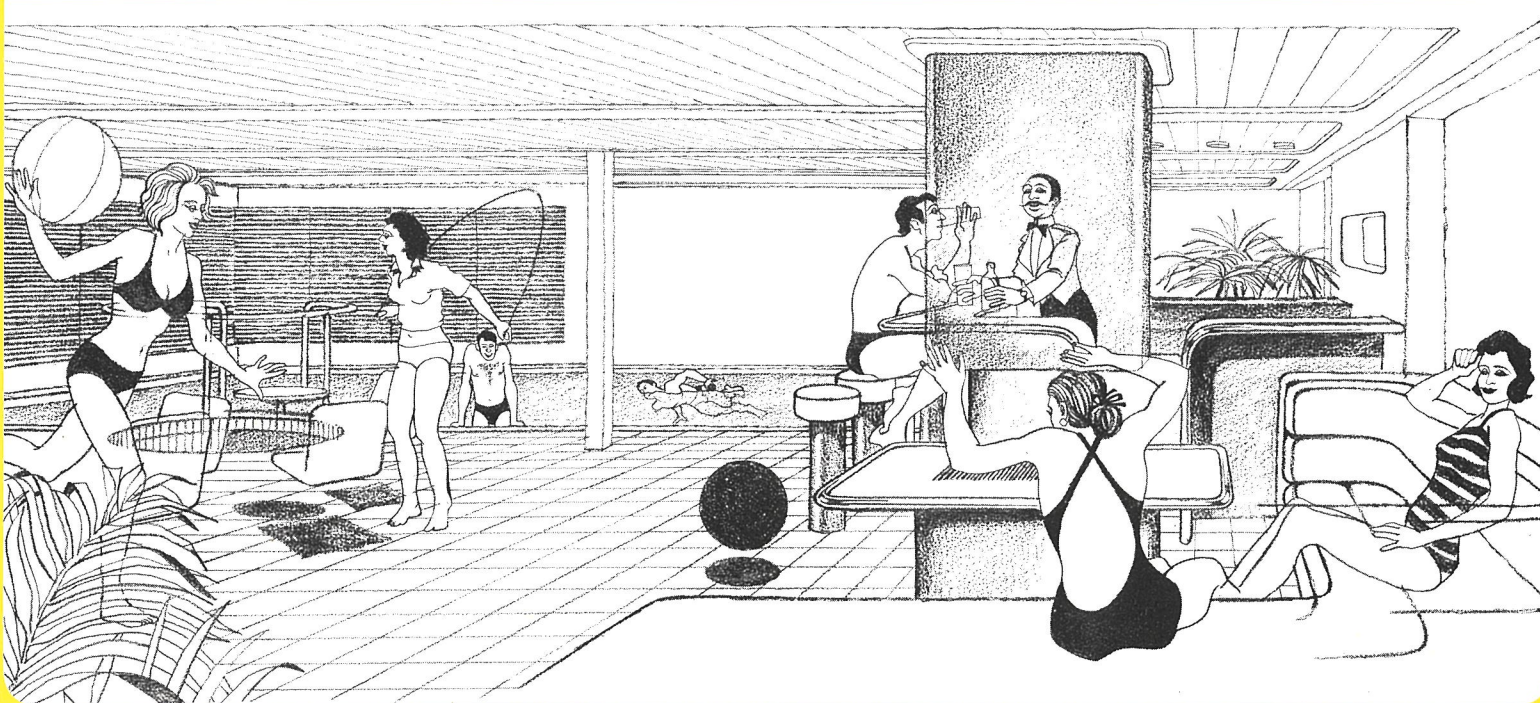

The swimming section has an 8-by-5-metre heated pool and a cold-water pool. There is seating in the hall for 40, a bar, a grill for roasting sausages and four solarium sunbathing spots. Adjoining the hall is a keep-fit room.

The ladies' beauty salon on deck 6 has two places for hair setting and three for drying, with all the appropriate shampooing and other equipment. Adjoining the beauty salon is a barber shop for one client. Also on deck 6 is the children's play room. The main attraction in the room is the "command deck" with a real ship's wheel, engine-room telegraph, and climbing masts. As the wheel turns the view from the command deck changes. A nautical atmosphere is created by waves, a lighthouse, and a helter-skelter slide on the theme of Jonah and the Whale. Next to the play room is a baby-care room for small children.

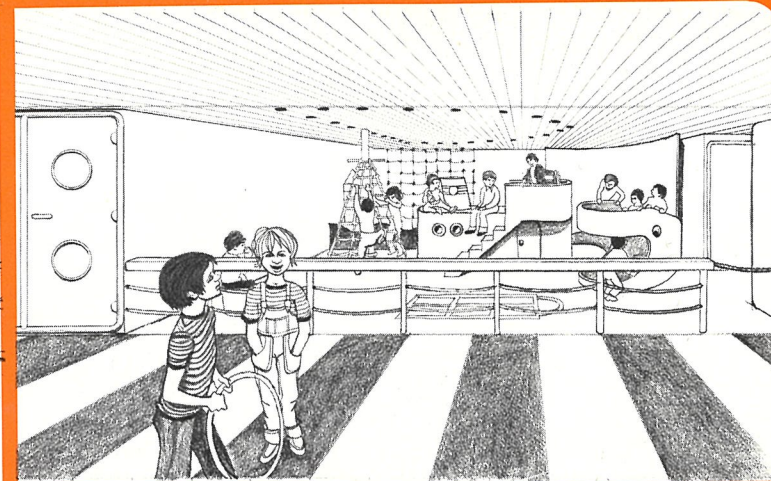
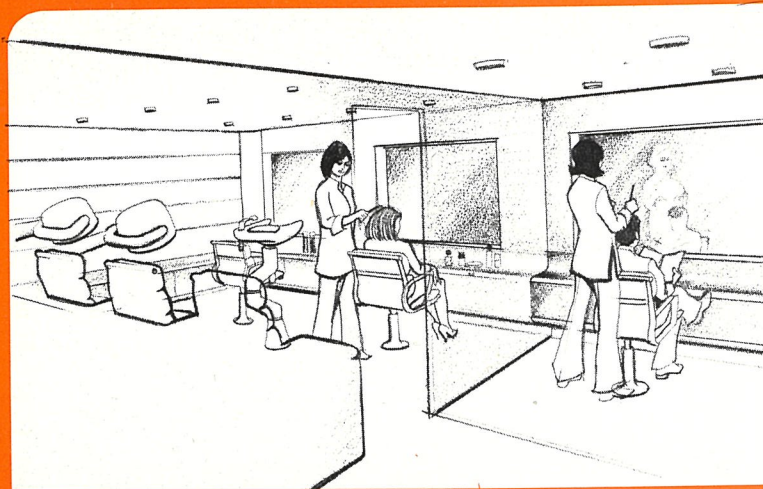

The shopping centre on deck 5 next to the main hall operates on the self service principle. Also on deck 5 in the hall is a boutique for design products, gifts, and souvenirs.

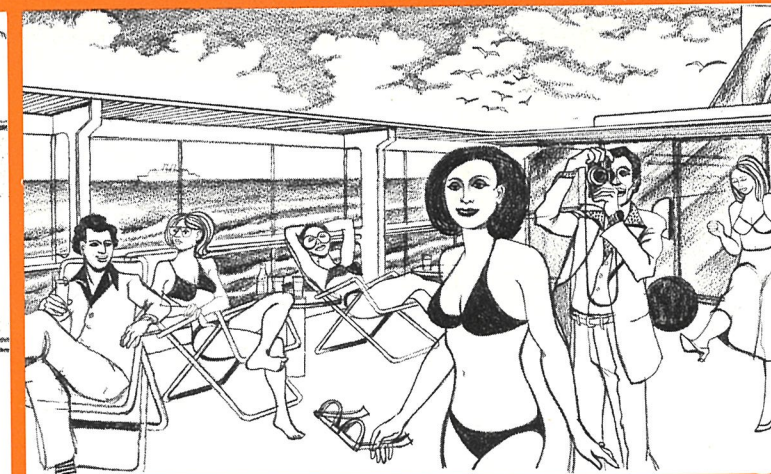
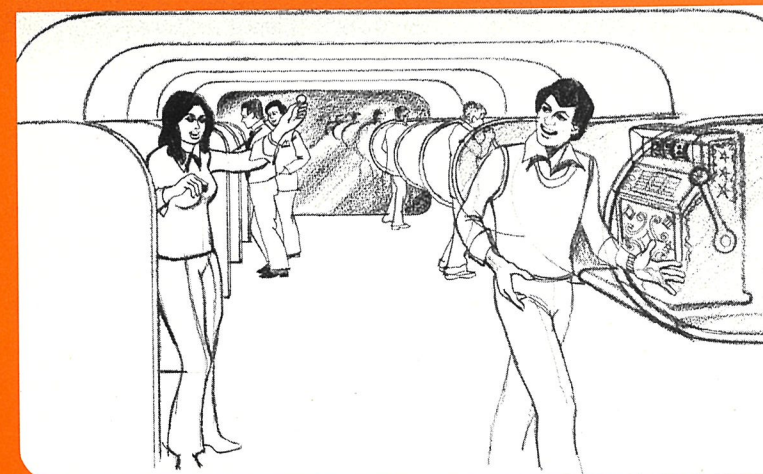

The gaming hall, with all the ship's gaming machines, is on deck 3. On the outer decks there is plenty of room to move about. Under the command bridge at the forepart of deck 7 is a sheltered viewing area; and at the other end of this deck is another sheltered area and its own kiosk. On deck 9 is a 550 sq.m. sun deck enclosed by windows on all sides.

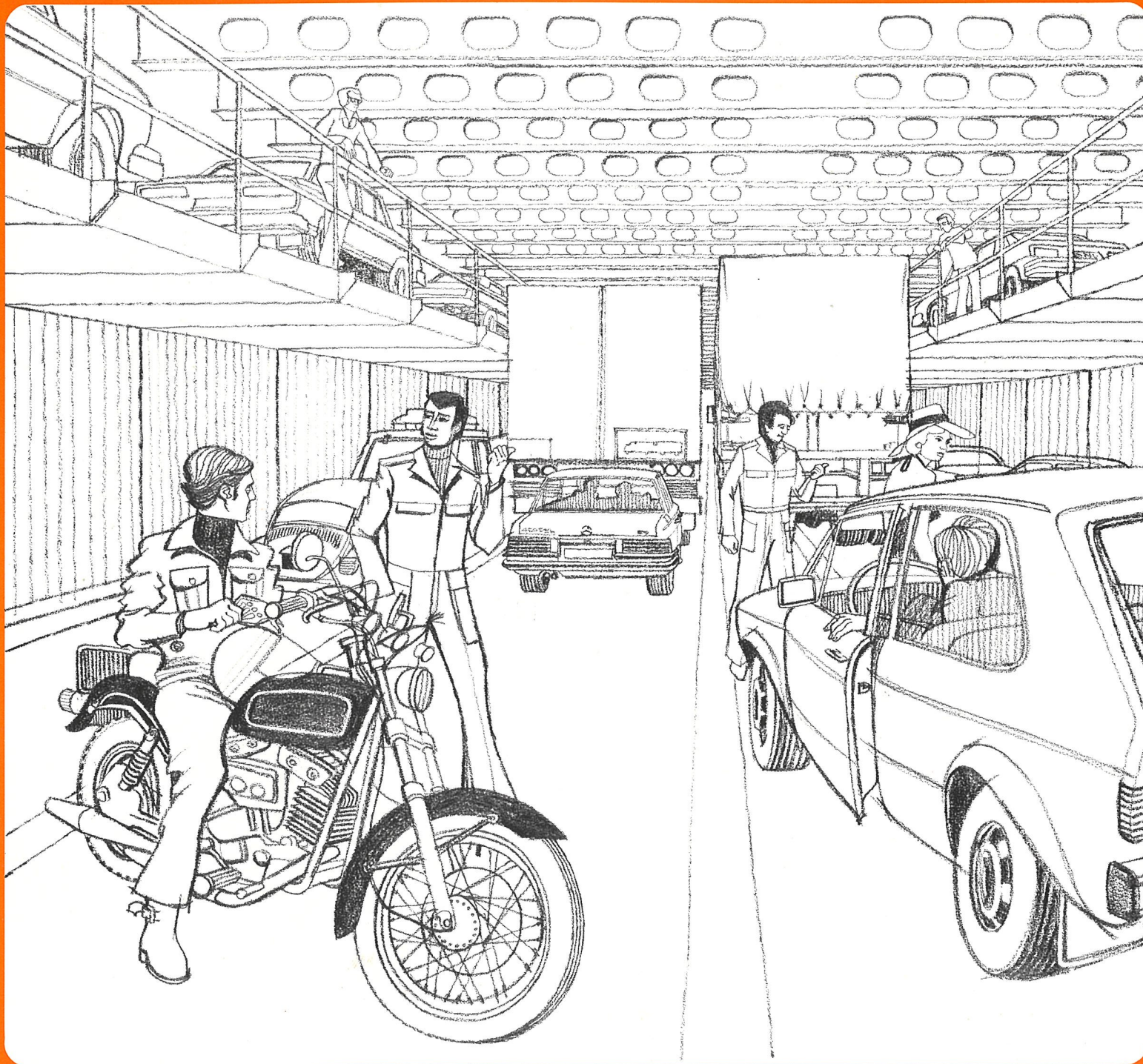

The car deck is almost 200 metres long, with room for four lorries side-by-side or, for example, two lorries and three cars. Above there are additional car sections that can be lowered to provide extra space. This flexible arrangement solves the problem of accommodating a varying number of cars and lorries, depending upon the season.

For the ship's crew there are 59 single and 46 double cabins located above the car deck, each with its own WC and shower.

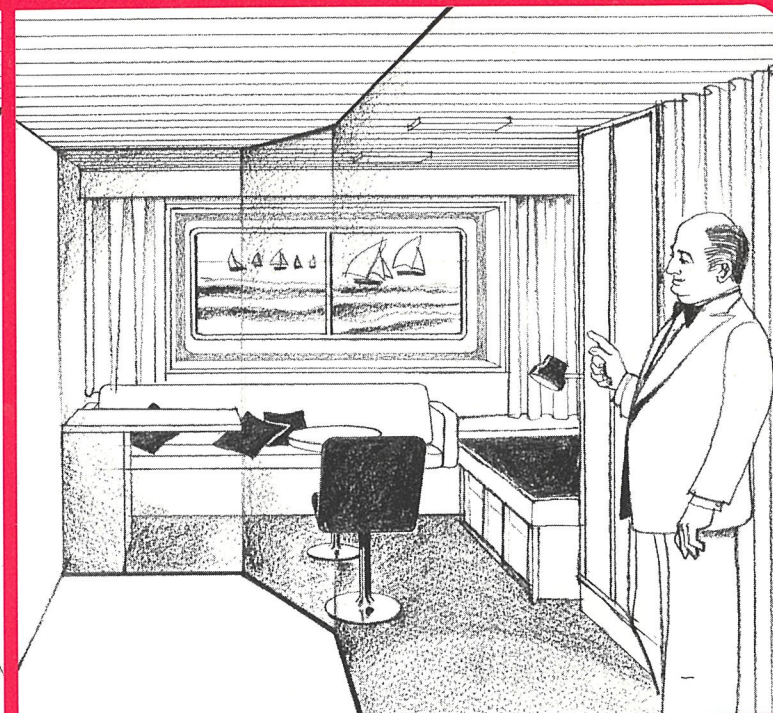
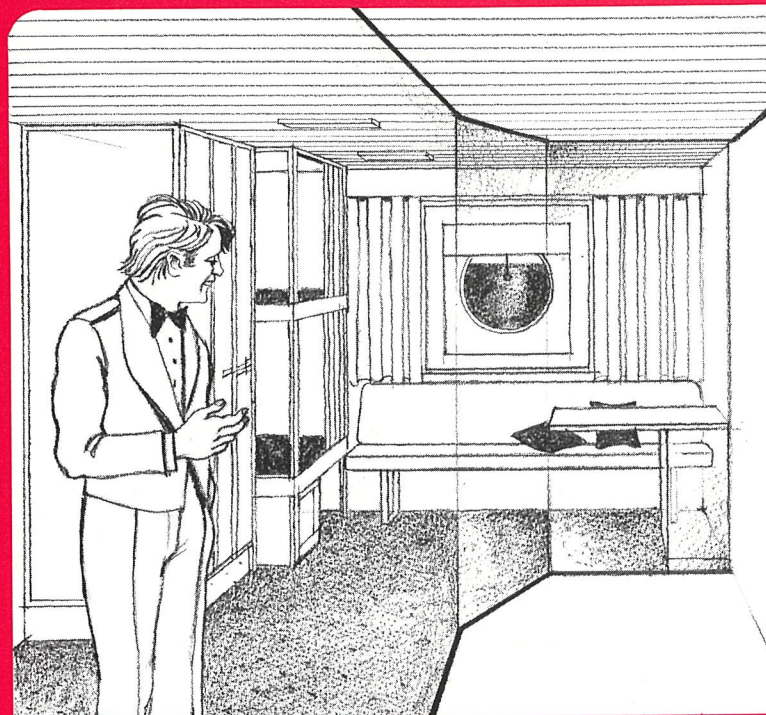

The staff have three dining rooms. During their time off they have the use of a leisure area for club activities and study, as well as a discotheque with a canteen. They also have three roomy saunas and two laundries.

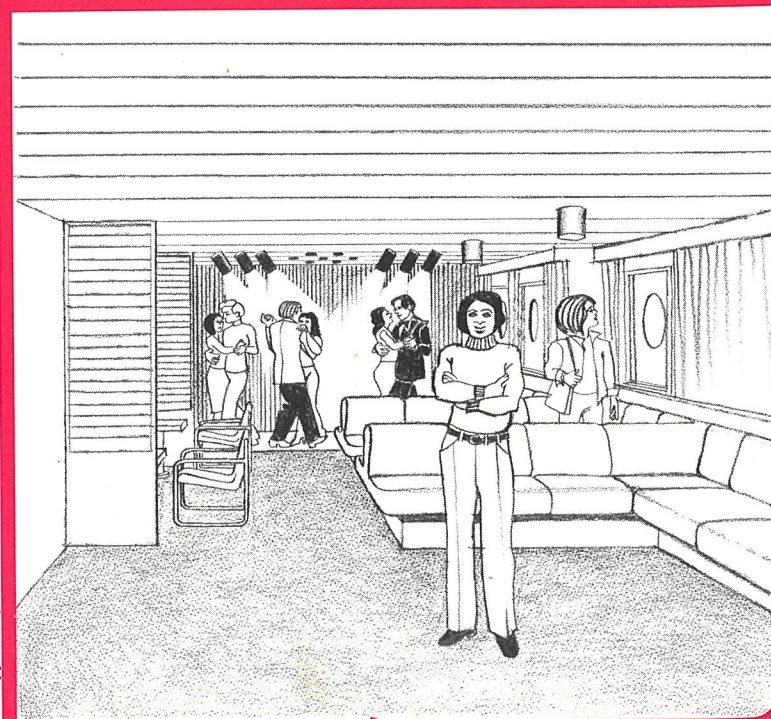

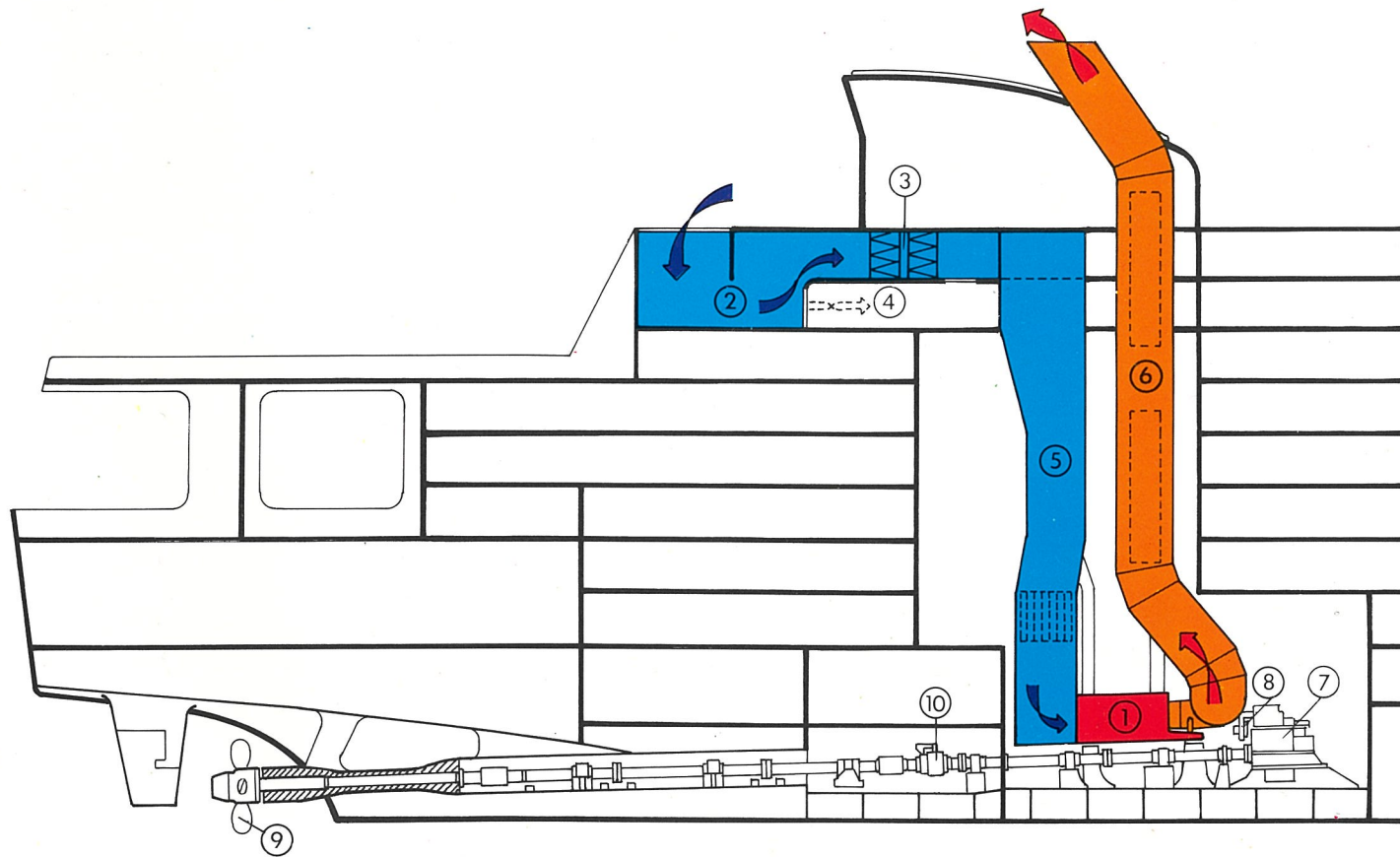
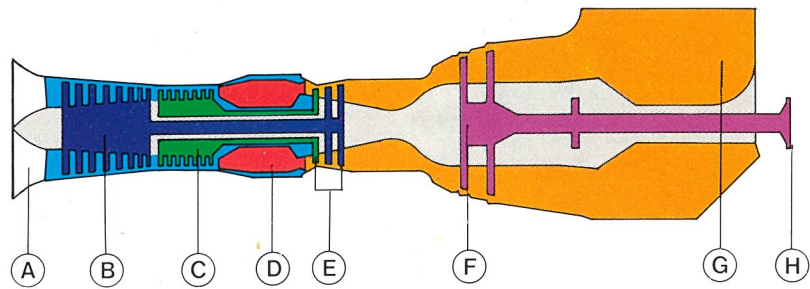

GAS TURBINE:

- A air inlet
- B low-pressure compressor
- C high-pressure compressor
- D combustion chambers
- E turbines
- F power turbine
- G exhaust outlet
- H power take-off

GAS TURBINE MACHINERY:

- 1. gas turbine
- 2. air inlet chamber
- 3. air filters
- 4. bypass channel
- 5. air vent and sound dampers
- 6. exhaust vent and sound dampers
- 7. reduction gear
- 8. disengaging couplings
- 9. variable pitch propeller
- 10. pitch control device

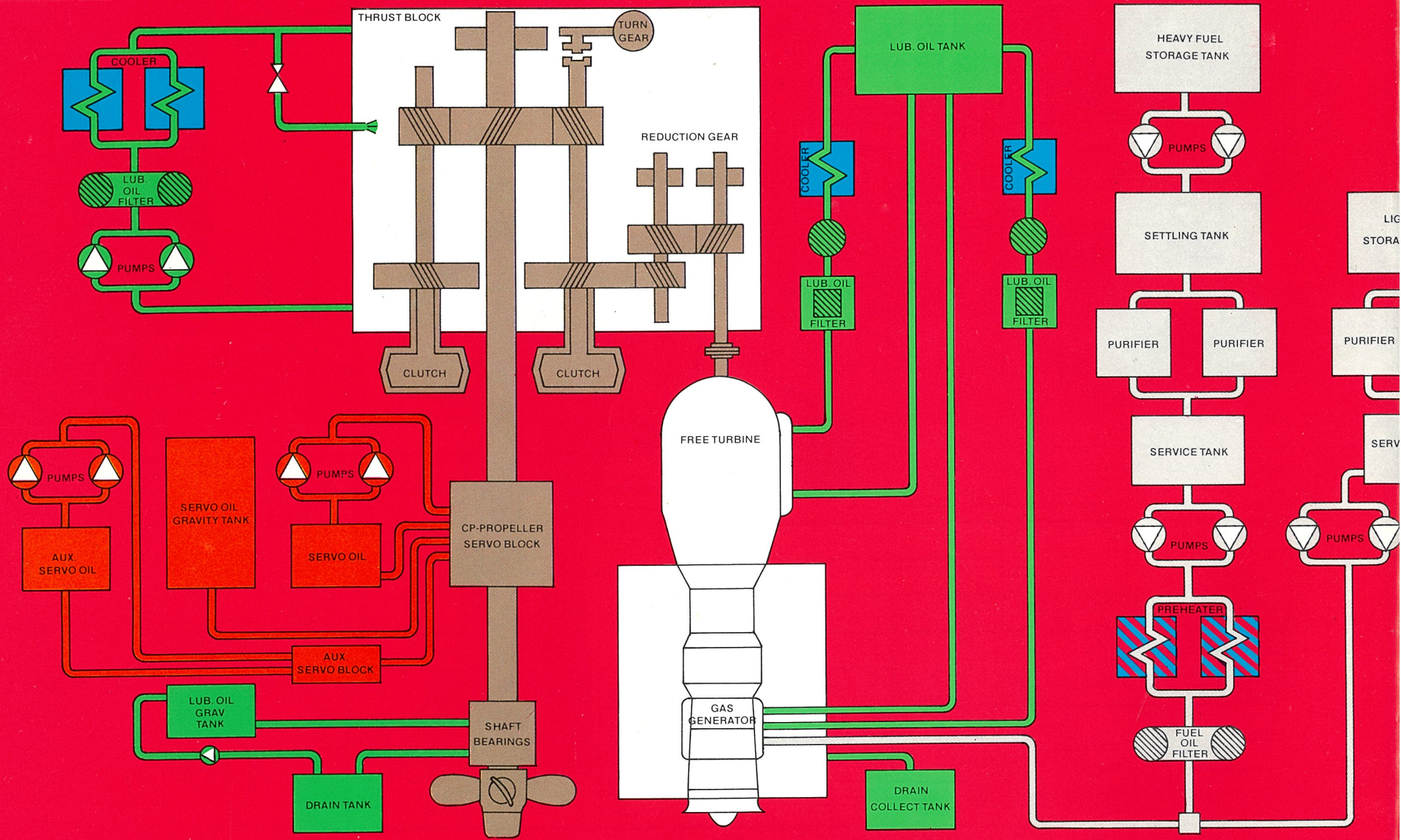

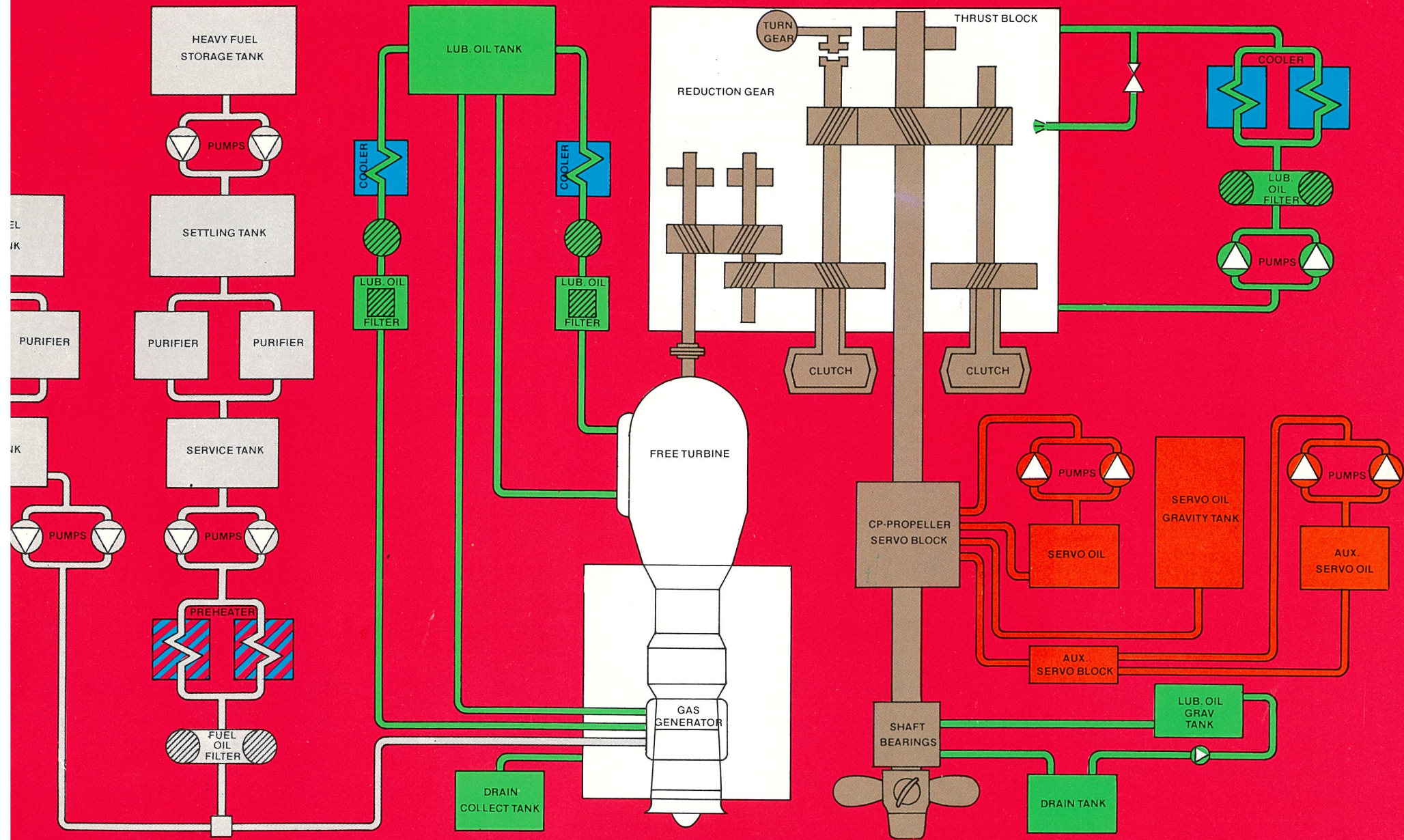

MAIN DIMENSIONS

Length, o.a.	212.8 m
Length, W.L.	200.0 m
Breadth	25.4 m
Draught	6.5 m
Draught at the propeller	7.2 m
Depth to the 4th Deck	14.8 m
Depth to the 7th Deck	23.2 m
Displacement	c. 16 500 m ³
Gross tonnage	c. 65 000 m ³

Net tonnage	(23 000 register tons)
	c. 32 500 m ³
	(11 500 register tons)

SPEED	30.5 knots
--------------	------------

DEADWEIGHT	2 500 tons
-------------------	------------

Passenger Cabin Spaces

A-cabin, 2 + 2 berths	12 m ² 156 cabins
B-cabin, 2 berths	8 m ² 306 cabins
C-cabin, 4 berths	4 m ² 74 cabins
Passenger capacity	1532

PUBLIC PASSENGER SPACES

Main Restaurant	480 m ² 342 seats
Grill Restaurant	260 m ² 166 seats
Multi-Purpose Saloon	575 m ² 377 seats
Dance Saloon	510 m ² 318 seats
Pub	60 m ² 56 seats
Nightclub	240 m ² 160 seats
Discotheque	40 m ² 37 seats
Sky Bar	240 m ² 150 seats
Main Halls	1000 m ² 120 seats
Sauna	150 m ²
Swimming-Hall	165 m ²
Gymnasium	50 m ²
Children's Playing Room	55 m ²
Hairdresser's, Barber's	20 m ²
Self-Service Shop	120 m ²
Shop	35 m ²
Slot Machine Room	30 m ²
Hospital	40 m ²
Luggage Storage	20 m ²
Passengers' Laundrette	10 m ²
Total area of public spaces	c. 4 000 m ²

CREW

Single cabin with two bedrooms	43 m ² 2 cabins
Single cabin with one bedroom	25 m ² 6 cabins
Single cabin	15 m ² 51 cabins
Double cabin	13 m ² 46 cabins

CARGO CAPACITY

Free height on car-deck	4.4 m
Free breadth at bow ramp	4.5 m
Free breadth at stern ramp	5.0 m
Cargo alternative A: Lorries	34
Buses	4
Cars	140
Cargo alternative B: Lorries	23
Buses	5
Cars	225
Cargo alternative C: Cars	350

TANK CAPACITY

Heavy distillate fuel oil	1750 m ³
Light distillate fuel oil	125 m ³
Diesel oil	125 m ³
Fresh water	1075 m ³
Boiler water	100 m ³
Ballast water	2100 m ³

PROPULSION MACHINERY

2 gas turbibes, Pratt & Whitney FT4C-1DLF	2 x 27.5 MW (2 x 37 500 hp)
Output	63.3 s ⁻¹ (3 800 R.P.M.)
Rate of revolution	274 kg/MWh (200 g/hph)
Fuel consumption	
2 reduction gears, Lohmann & Stolterfoht GUY 7733	
2-step, equipped with 2 disengaging couplings	
Reduction ratio	22.245:1
2 controllable pitch propellers, KMW 179 s1/4	
Diameter	5.0 m
Rate of revolution	2.85 s ⁻¹ (171 R.P.M.)
Computer control of the gas turbine and measuring and alarm equipment:	
AEG Schiffbau	

AUXILIARY MACHINERY

5 diesel generators, Wärtsilä 12V22+Strömberg HSPTL/R11/753 B16	
Output	1 700 kVA cosfi 0.8
Rate of revolution	25.0-1 (1 500 R.P.M.)
1 emergency diesel generator	
Output	500 kVA cosfi 0.8
Rate of revolution	25.0-1 (1 500 R.P.M.)

BOILERS

2 boilers	
Output	1.94 kg/s (7 000 kg/h)
Pressure	0.7—0.8 MPa (7—8 kp/cm ²)

CONSTRUCTION RULES

General:	Det Norske Veritas + 1A1 Car Ferry A
Machinery control:	Det Norske Veritas EO
Navigation equipment:	Det Norske Veritas NAV A

Ice strengthening:

Finnish Iceclass 1A Super at the output 14.6 MW/propeller (20 000 hp/propeller)

Safety:

SOLAS 1960, fire protection in accordance with Metod 1, including the additions to Chapter II parts G and H.

EQUIPMENT

- 10 shell doors, hydraulic
 - 1 bow gate and ramp, free breadth 4.5 m
 - 1 stern ramp, free breadth 5.0 m
- 15 watertight sliding doors
- 430 windows
 - 2 anchor windlasses for 66 mm chain
 - 4 mooring winches, self-tensioning, max. power 200 kN
 - 2 rudders, area 9.5 m²
 - 1 steering gear, torque 1 200 kNm
 - 2 bow thrusters, thrust 110 kN
- 10 lifeboats, 102 persons
 - 1 lifeboat with radio cabin, 50 persons
 - 1 lifeboat, 65 persons
- 12 lifeboat davits, electric drive
- 36 liferafts, 20 persons, launching by davits
- 10 liferafts
 - 2 fin stabilizers, retractable, max. lift 650 kN
 - 2 car platforms, divided into sections, total length c. 2 x 150 m, breadth 2.6 m and 5.0 m
 - 4 passenger lifts, 8 persons or 640 kg, automatic doors
 - 2 lifts for passengers and goods, 500 kg
 - 1 lift for provisions, 75 kg
 - 1 crane for provision containers, max. load 15 000 kg, reach 5.0 m out from SB or BB side of the ship
 - 1 landing space for helicopter, max. helicopter weight 9700 kg, 3 landing trolleys.

NAVIGATION EQUIPMENT

- 1 gyro compass system
- 2 radars, Raytheon 10 cm TM/CPA 1660/15S, 3 cm RM 1645/12X
- 1 computer-controlled navigation system, Norcontrol
- 1 echo sounder
- 1 log
- 1 radio-navigator
- 1 navigation equipment alarm panel
- 1 navigation TV-system, 5 cameras, 5 monitors in the wheelhouse and in the machinery control room
- 1 radio station
- 1 weather chart recorder

INTERNAL COMMUNICATIONS

- 1 battery telephone system, 18 extensions
- 1 docking telephone system
- 1 automatic telephone system with hotel exchange, 90 main lines, 14 registers, 630 extensions
- 1 loudspeaker telephone system, duplex communication, 60 apparatuses
- 1 hunting device system, 60 receivers

RADIO, AMPLIFIER AND TV-SYSTEMS, Philips

- 1 central radio and loudspeaker system, 3 programs, 18 groups
- 3 separate amplifier centers
- 1 conference equipment, 1 chairman's device, 65 participant's devices, 90 sockets
- 1 internal TV-system, 1 video-recorder, 1 telecine unit, 1 movable camera, 14 camera points
- 1 central aerial system for radio and TV

ACCOMMODATION

- Interior design by: A Nurmesniemi, V & T Laakso, A Kukkasniemi, P Perjo, Y Wegelius
- 30 000 m² wall cassettes of steel plate and mineral wool, faced with laminated plastic
- 572 pre-fabricated WC-shower units
- 1 490 B-class interior doors
- 153 A-class fire doors
- 12 600 m² wall-to-wall carpet
- Galley and pentry design and equipment, Elektrohelios
- 2 film projectors, 35 mm
- 1 film projector, 16 mm

PAINTING

- Hull below W.L.:
 - 1 solvent-free epoxy, 500 my, 6 000 l
 - 2 anti-fouling, 2 000 l
- Hull and decks:
 - 4 thick-film vinyl, 230 my
- Fresh-water tanks, fuel tanks:
 - 2 thick-film epoxy, 250 my, 7 500 l
- Ballast tanks:
 - 2 tar-epoxy, 250 my, 7 000 l
- Car decks:
 - 1 ethyl zinc silicate, 75 my, 1 000 l
- Interiors:
 - thick-film bituminous paint, 4 500 l
 - alkyd-based paints, 65 000 l

CORROSION PROTECTION

- 1 electric corrosion protection system for hull, 8 anodes, 2 reference anodes

SEWAGE SYSTEM

- 600 vacuum WC-bowls
- 2 vacuum sewage tanks with pumps, 29 m³
- 1 sewage water purifying plant, 137 m³/24 h
- 1 sewage water chlorination tank, 25 + 25 m³

VENTILATION

- The heating and cooling equipment for the interior ventilation is dimensioned to keep the indoor temperature between +20...22°C, when the outdoor temperature is -25°C in winter, or +27°C in summer with a relative humidity of 80 %
- 26 interior central aggregates
- 28 interior exhaust ventilators
- 2 cooling compressors for ventilation, 1 220 MW
- 8 car-deck ventilators, air changes 24 times/h in port, 12 times/h at sea, and 6 times/h in winter at sea
- 46 ventilators for machinery and storage spaces

FIRE PROTECTION

- Fire alarm system consisting of 1600 heat, smoke or gas detectors
- Remote closing system for 61 A-fire-doors
- 3 firepumps, 130 m³/h
- 1 sprinkler system for the car deck, 2 x 200 m³/h
- 88 CO₂-cylinders for machinery spaces, 45 kg

AUXILIARIES

- 2 central coolers, 3 200 MW
- 6 fuel oil separators
- 2 lubricating oil separators
- 2 fuel oil filter sets

MACHINE AUTOMATION AND CONTROL EQUIPMENT

- 1 automatic stopping and starting system for diesel generators
- 17 stand-by and re-start system
- Alarm, measuring and automatic registering system comprising 371 points
- Remote sounding equipment and remote valve control system comprising 32 points
- 1 TV-control system, 3 cameras, 3 monitors

HEELING AND TRIMMING SYSTEMS

- 1 heeling pump with automatic control, 2 800 m³/h
- 2 trimming pumps with automatic control, 2 500 m³/h

ELECTRICITY

- Main and emergency distribution panels, 380V and 220V, 3-phase 50 Hz
- 7 transformers, 380/220V, 3-phase, 190 kVA
- 2 transformers, 380/220V, 3-phase, 75 kVA
- 10 500 light outputs
- 12 outlets for refrigerating plant, 380V 50 Hz
- 4 outlets for refrigerated lorries, 380/220V 50 Hz



FINNJET — a speedy voyage in safe hands

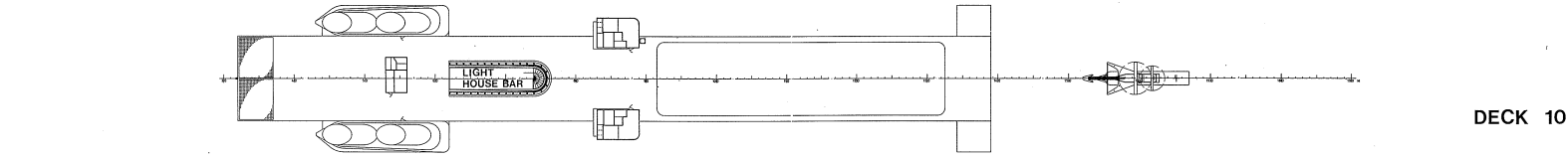
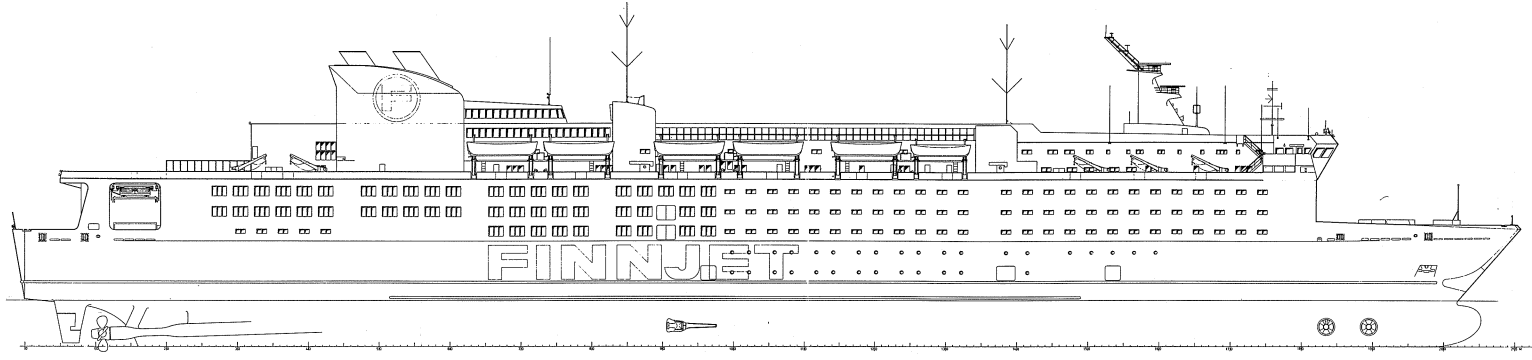

DECK 10

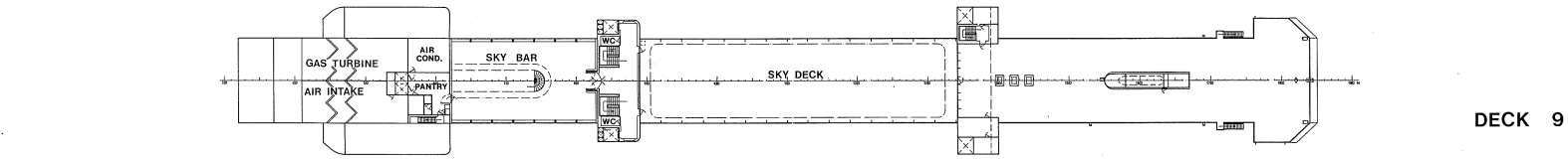

DECK 9

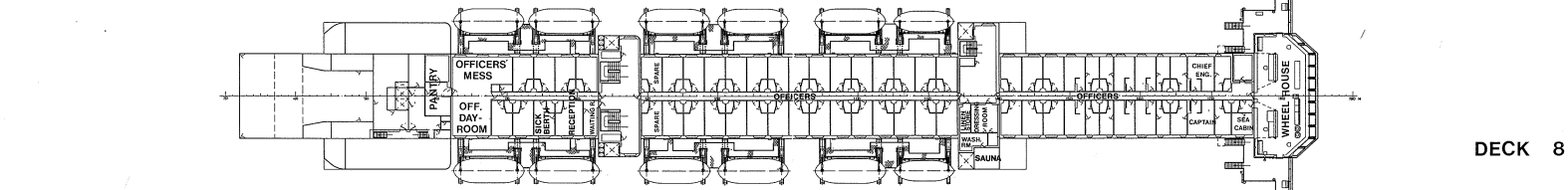

DECK 8

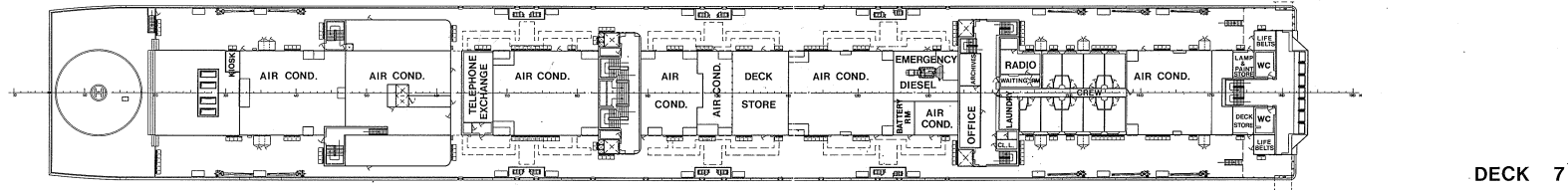

DECK 7

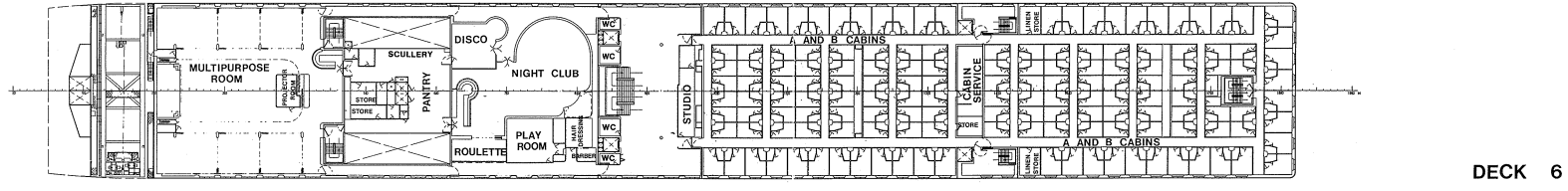

DECK 6

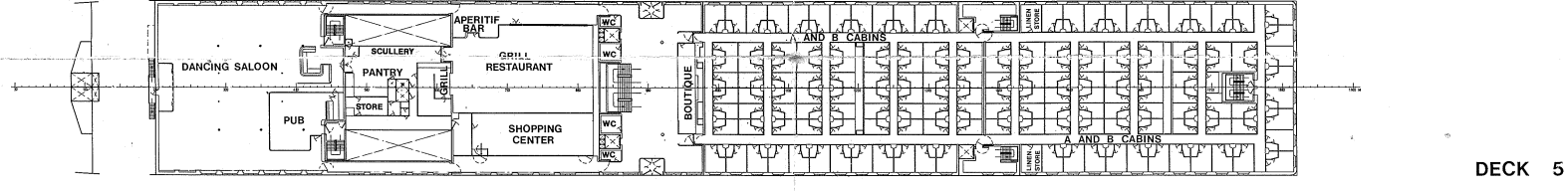

DECK 5

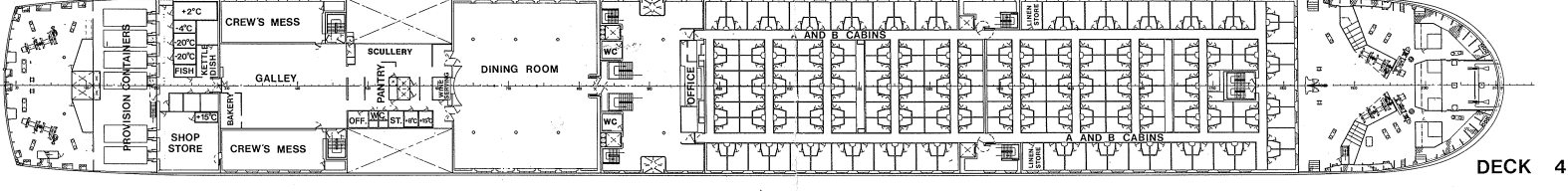

DECK 4

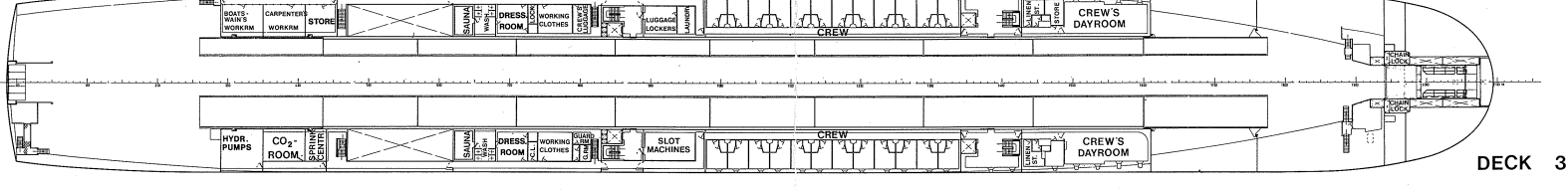

DECK 3

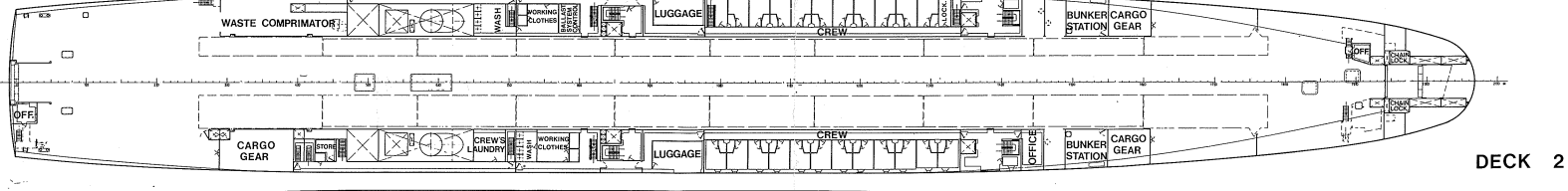

DECK 2

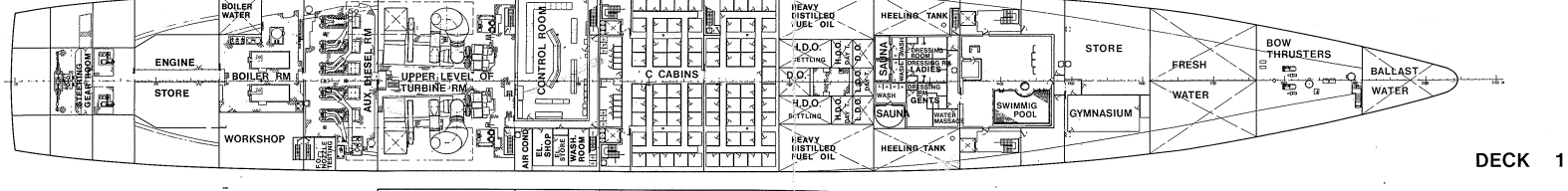

DECK 1

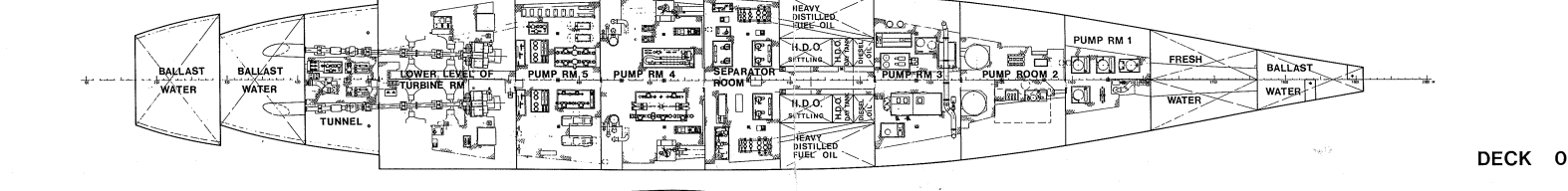

DECK 0

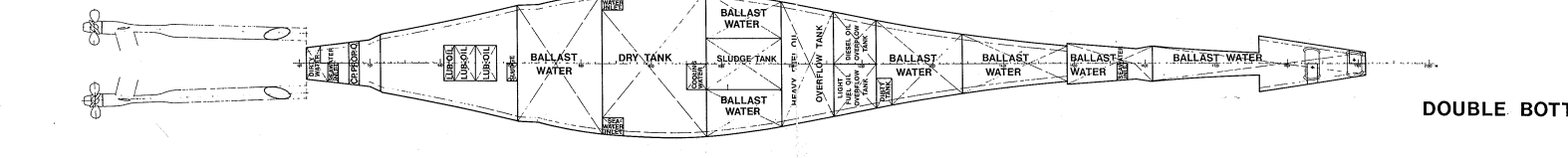

DOUBLE BOTTOM

